

EK Hollow Pin Chain

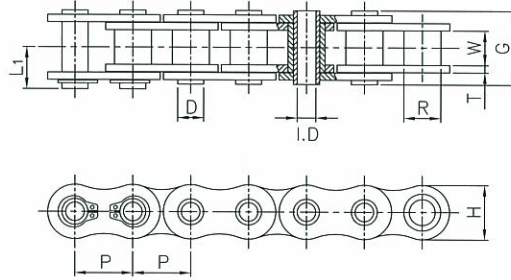

(mm)

EK Chain No.	Pitch P	Roller Dia. R	Roller Link Width W(min.)	Pin Dia. D	Pin I.D. (min.)	Pin Length		Link Plate		Average Tensile Strength kN	Maximum Allowable Load kN	Approx. Weight Kg/Meter
						L1	G	Thickness T	Height H(max.)			
EK 40HP	12.700	7.94	7.85	5.61	4.01	9.10	16.60	1.50	12.0	10.7	1.70	0.56
EK 50HP	15.875	10.16	9.40	7.15	5.13	11.40	20.10	2.00	15.0	19.6	3.10	0.96
EK 60HP	19.050	11.91	12.57	8.41	5.97	14.10	25.00	2.40	18.1	26.4	4.20	1.32
EK 80HP	25.400	15.88	15.75	11.35	7.97	17.90	31.00	3.20	24.1	55.8	8.90	2.07

Double Pitch Type

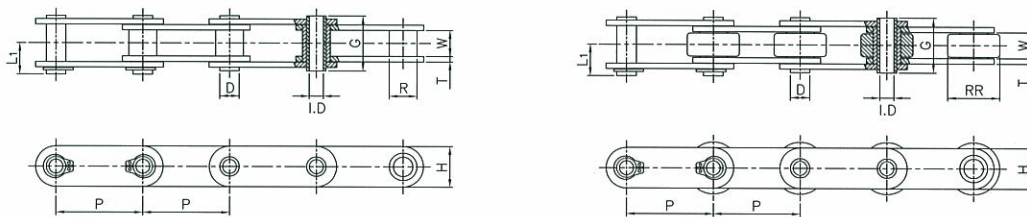

(mm)

EK Chain No.		Pitch P	Roller Link Width W(min.)	Roller Diameter		Pin Dia. D	Pin I.D. (min.)	Pin Length		Plate		Average Tensile Strength kN	Maximum Allowable Load kN	Approx. Weight	
Standard Roller	Large Roller			Standard Roller R	Large Roller RR			L1	G	Thickness T	Height H(max.)			Standard Roller Kg/Meter	Large Roller Kg/Meter
EKC2040HP	EKC2042HP	25.40	7.85	7.94	15.88	5.61	4.01	9.1	16.6	1.5	11.7	10.7	1.7	0.44	0.76
EKC2050HP	EKC2052HP	31.75	9.40	10.16	19.05	7.15	5.13	11.4	20.1	2.0	14.9	19.6	3.1	0.72	1.15
EKC2060HP	EKC2062HP	38.10	12.57	11.91	22.23	8.41	5.97	14.1	25.0	2.4	17.0	26.4	4.2	0.99	1.68
EKC2080HP	EKC2082HP	50.80	15.75	15.88	28.58	11.35	7.97	17.9	31.0	3.2	23.0	55.8	8.9	1.67	2.50

NOTE:

- 1) Heavy link plate for EK C2060HP(3.2mm) and EKC2080HP(4.0mm) is available.
- 2) Nickel plated and stainless steel chain is available.